



# Clean & Comfy Booster Seat

015611 / BO069 User Guide

**Age: 6 months to 4 years.**  
**Maximum weight: 20 kg.**  
**Adult assembly required.**



## ⚠ WARNING:

- Prevent serious injury or death from sliding out, falls, or tipping over.
- **ALWAYS** secure child in the restraint until child is able to get in and out of the booster seat without help (about 2-1/2 years old). The tray, if supplied, is not designed to hold the child in the chair.
- **NEVER** leave child unattended.
- **NEVER** allow a child to push away from table.
- **ALWAYS** fasten seat and back straps securely to adult chair.
- **ALWAYS** check security of fit to adult chair before each use.
- This booster seat is only to be used with standard kitchen or dining room chairs. **NEVER** use this product as a car seat or bath seat, on a tabletop, stool, swivel chair, or any other seating surface where the straps cannot secure it properly.
- Prevent serious injury or death. **NEVER** use in motor vehicles.
- **ALWAYS** ensure that all chair protector pads are located completely on the adult chair surface.
- **Discontinue use if damaged, broken or if parts are missing.**

## ⚠ CAUTION:

- Keep small parts away from children during assembly.
- Remove all contents from packaging and discard box and/or poly bags.
- Lay out and identify all parts.
- **Before Assembly:** Wipe down trays with a soft cloth and warm soapy water.
- Do not return this product to the place of purchase. If any parts are missing, please contact our Customer Service Team:

### Dorel Australia Pty Ltd

655-685 Somerville Road  
Sunshine West, Victoria, 3020  
Melbourne: (03) 9311 5300  
Australia wide (local call cost): 1300 809 526  
Hours: 8:30 am - 5:00 pm, Monday to Friday  
Email: customerservice@dorel.com.au

### IGC Dorel New Zealand Ltd

14 Sir William Avenue  
East Tamaki, Auckland, 2013  
Auckland: (09) 274 1040  
NZ wide (toll free): 0800 628 000  
Hours: 8:00 am - 5:00 pm, Monday to Friday  
Email: customerservice@igc.co.nz

Have ready the model number (015611) and date code (manufacture date) located on underside of the booster seat base.

## Parts List

- |  |                                |
|--|--------------------------------|
| <b>A</b> Insert tray                   | <b>F</b> Base                  |
| <b>B</b> Tray                          | <b>G</b> Adult chair topper    |
| <b>C</b> Seat                          | <b>H</b> Protector pad (3)     |
| <b>D</b> Waist restraint               | <b>I</b> Chair straps (2 sets) |
| <b>E</b> Seat attachment hooks & snaps | <b>J</b> Tray release          |

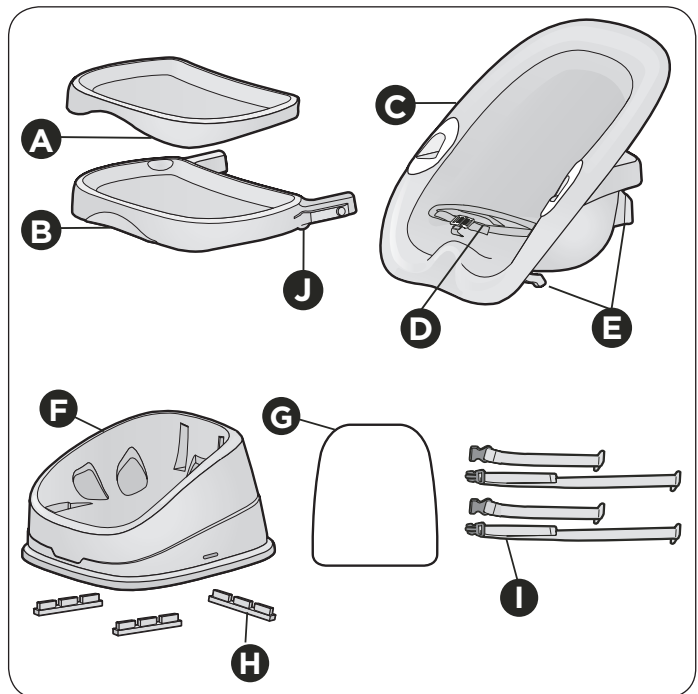

## To Assemble

### 1 Preassembled Parts C D F H:

Three protector pads (Figure 1a) and child waist restraint (Figure 1b) will come preassembled to base and seat, respectively.

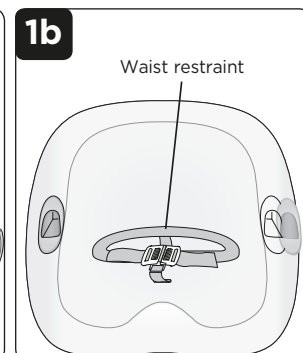
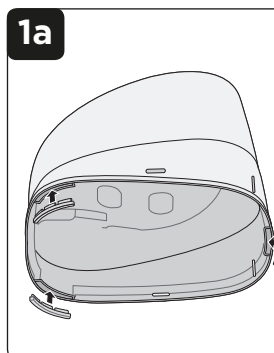

© 2014 Dorel Australia Pty Ltd. All Rights Reserved.  
Made in CHINA AX: 015611 09/14

## To Assemble (continued)

### 2 Attach Seat **C E F**:

Place seat face-down on flat surface with hooks and snaps facing upward (**Figure 2a**). Align base and seat as shown (**Figure 2b**). Turn seat so that underside of the base faces towards you. Insert hooks on the seat into the corresponding slots on the base (**Figure 2c**). Ensure hooks are inserted correctly; locking tabs should slide beneath them (**Figure 2d**).

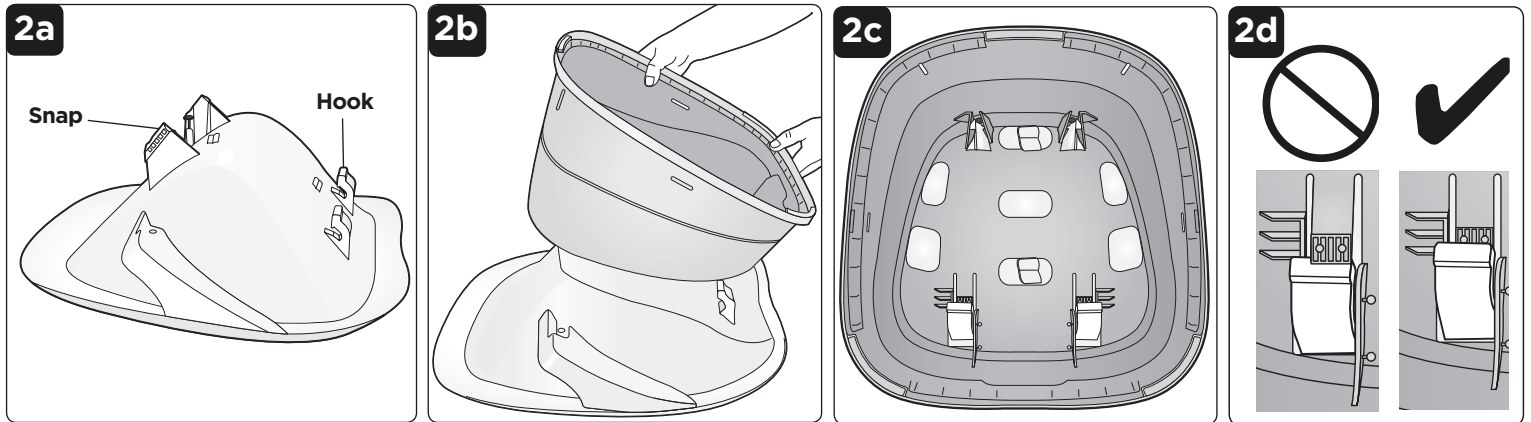

### 3 Secure Seat **E F**:

Place hands on seat base as seen below and firmly push base until it is fully engaged with seat (**Figure 3a**). After seat clicks into place, ensure that hooks and snaps are locked and secure as seen below (**Figure 3b**).

**Note:** If seat is not secure, use force to push base onto seat to ensure proper attachment.

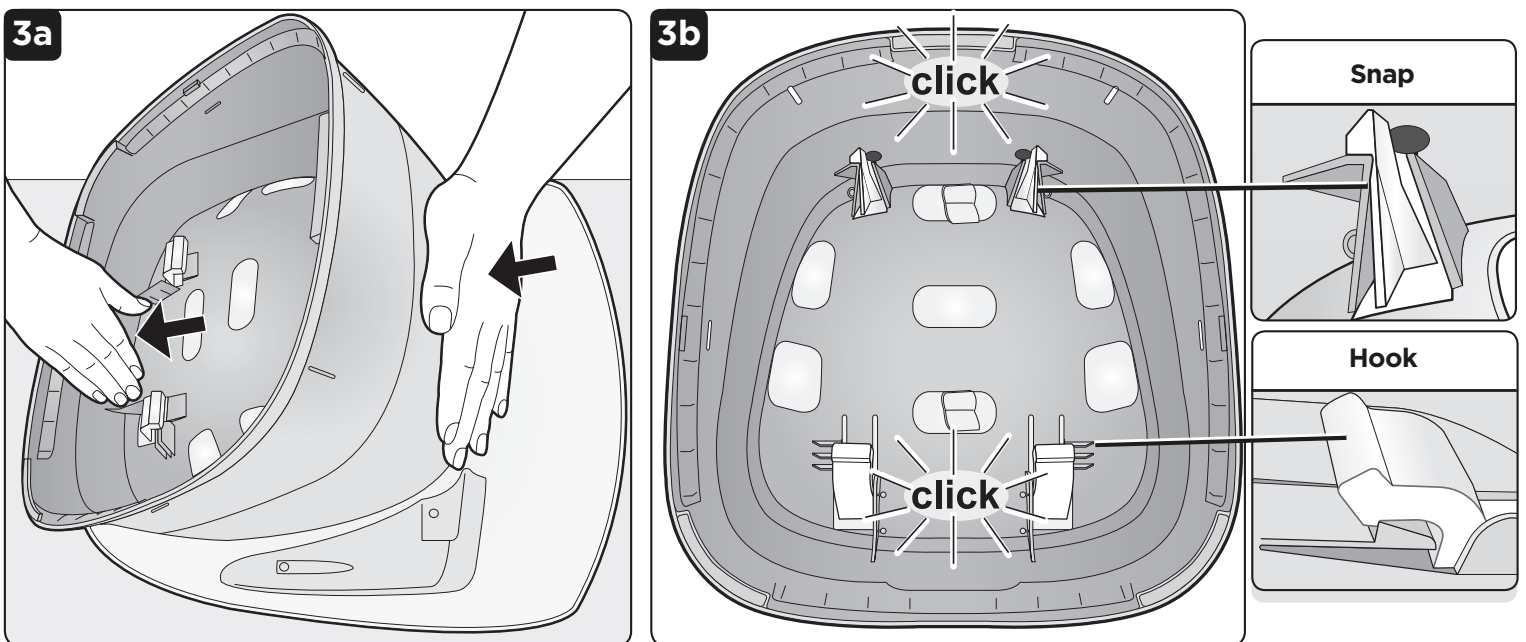

### 4 Attach Chair Straps (2 sets) **F I**:

Locate chair straps. Snap buckles together (**Figure 4a**).

With one set of straps, insert folded ends into two openings on back of the base (**Figure 4b**).

With second set of straps, insert folded ends into two openings on either side of the base (**Figure 4c**).

Pull each strap to ensure strap is secure.

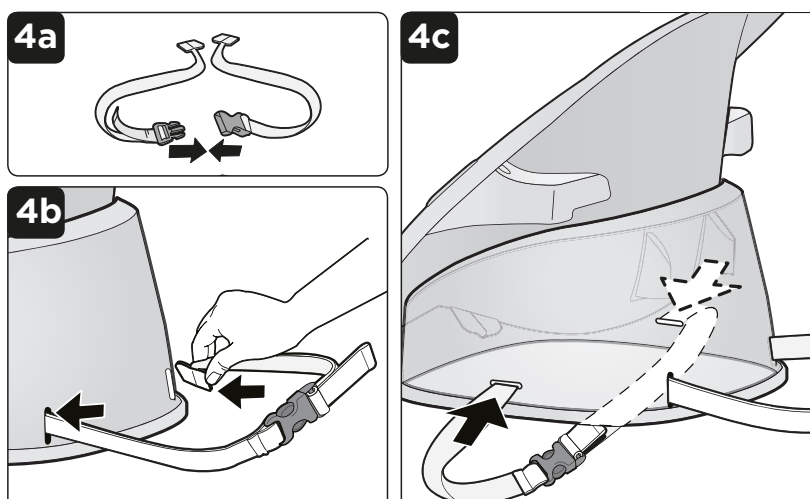

## To Use

### 1 Protect Adult Chair

Place chair topper on adult seat (**Figure 1a**).

Place seat on chair, over chair topper (**Figure 1b**).

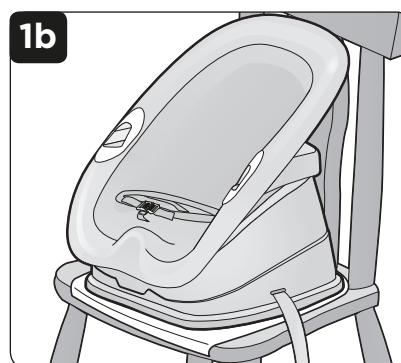
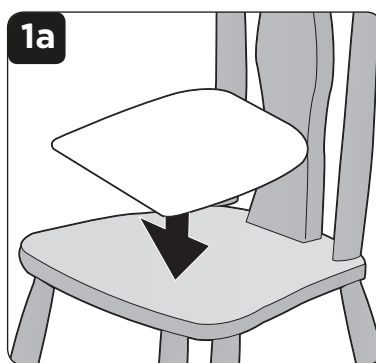

### 2 Chair Straps

Pass the bottom chair strap completely under base of chair and secure buckle (**Figure 2a**). Tighten chair strap for security.

Pass rear chair strap around back of chair and secure buckle (**Figure 2b**). Tighten chair strap for security.

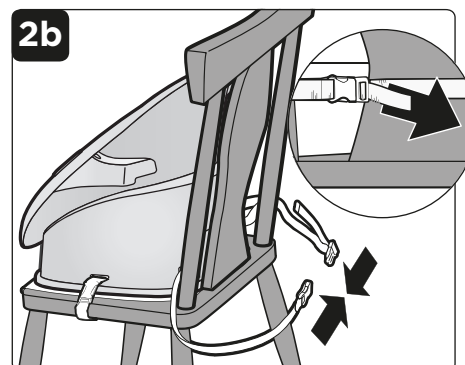
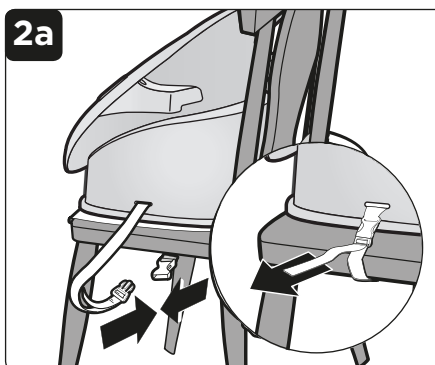

### **WARNING:**

- **ALWAYS** use both sets of chair straps to completely secure booster to the chair.
- If chair is cushioned and cushion cannot be removed, **BE CERTAIN** that the bottom chair strap is fastened snugly after putting child in seat.

- Make sure all pieces are assembled correctly. Test for proper assembly before placing child in seat.
- **ALWAYS** secure child in booster seat using restraint straps.
- **ALWAYS** ensure that all chair protector pads are located completely on the adult chair surface.

### 3 Restraint System

Position your child in booster seat. Place restraint straps between legs and buckle into position (**Figure 3a**). Adjust restraint straps for proper fit (**Figure 3b**).

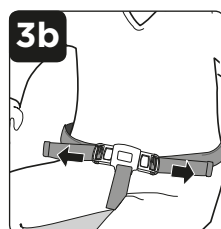
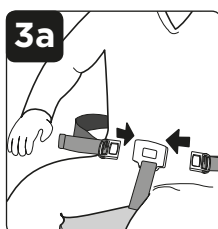

### 4 Attach Tray

Slide tray into slots on either side of seat until it clicks into place. Pull on tray to ensure that it is completely engaged (**Figure 4a**).

**Insert tray:** Align on main tray for use.

**To remove tray:** Depress tray releases on both sides of tray and pull away from seat (**Figure 4b**).

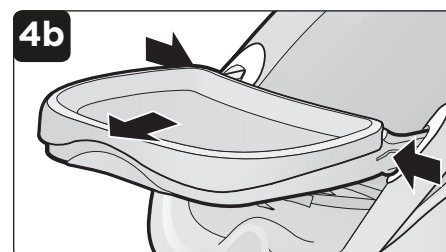
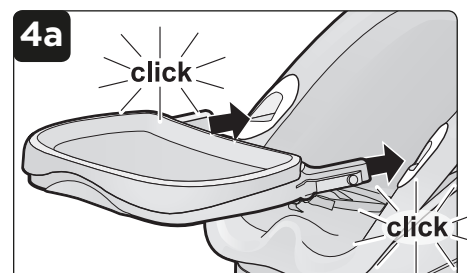

### **WARNING:**

The tray is not a restraint device. **ALWAYS** use restraint straps to secure child to booster seat.

## To Clean

### Booster and Tray:

Clean before first use and after each use. Wipe with soft cloth and warm soapy water. Use only mild non-abrasive soap. Both trays are dishwasher safe (top rack only).

**Dorel Australia Pty Ltd**

655-685 Somerville Road  
Sunshine West, Victoria, 3020  
Email: [customerservice@dorel.com.au](mailto:customerservice@dorel.com.au)  
Phone: 1300 809 526  
Hours: 8:30 am - 5:00 pm, Monday to Friday

**IGC Dorel New Zealand Ltd**

14 Sir William Avenue  
East Tamaki, Auckland, 2013  
Email: [customerservice@igc.co.nz](mailto:customerservice@igc.co.nz)  
Phone: 0800 628 000 (toll free)  
Hours: 8:00 am - 5:00 pm, Monday to Friday



Specifications are subject to change without notice.  
Copy or reproduction without permission is prohibited.  
© 2013 Dorel Australia Pty Ltd. All Rights Reserved.  
[www.dorel.com.au](http://www.dorel.com.au)

Join Us on facebook   
[www.facebook.com/Safety1stAustralia](http://www.facebook.com/Safety1stAustralia)